

Noritsu D701

Specifications



Print receiving tray:	When the paper advance length is 102 mm or shorter: 100 sheets When the paper advance length is 103 mm or longer and 178 mm or shorter: 50 sheets When the paper advance length is 179 mm or longer and 254 mm or shorter: 20 sheets When the paper advance length is 255 mm or longer and 457 mm or shorter: 3 sheets
Long length print guide (option):	When the paper width is 203 mm or 254 mm, and the paper advance length is 485 mm or longer: 1 sheet
Ink	Noritsu-specified dye ink cartridges (Cyan, Magenta, Yellow and Black), 500 ml per color
Heating capacity	Approx. 437.3 W (Approx. 376.1 kcal/h)

Printer PC

Noritsu recommends the following PC specifications.

Item		Explanation
Model		PC/AT compatible system (DOS/V system)
OS		Windows XP Professional English version (SP2 or later) *1
CPU		CeleronD 3.2 GHz or higher *2
Memory		512 MB or more DDR2
Drive	CD-ROM drive *3	1
	Hard disk	40 GB or more (1.5 GB or more free space in the system drive)
Interface	LAN	Ethernet 1000 Base-T
	USB 2.0	3 ports or more (for connecting a printer *4, mouse and keyboard)

*1. OS has been already installed on C drive.

*2. **Wakeup On LAN (WOL)** is supported by NIC and motherboard, and **Wakeup On LAN (WOL)** is valid in the BIOS.

*3. CD-R/RW drive or DVD-ROM drive etc. can also be used.

*4. The following conditions must be satisfied.

- While the printer PC is off, power is not supplied to the USB devices.
- Can supply 5 V±5% of power voltage and 500 mA of power current.

NOTE

- The printer computer mount supplied with this product can support the weight, up to 20 kg. If using the printer computer mount, prepare a printer computer whose weight is 20 kg or less.

Operation PC

Install Noritsu Quick Access or EZ Controller to the operation PC to print images with this printer.

■ Operation PC (for Noritsu Quick Access)

Noritsu recommends the following PC specifications.

Model		PC/AT compatible system (DOS/V system)
OS		Windows 2000 Professional SP4 or later (only Japanese or English)
		Windows XP Professional SP2 or later (only Japanese or English)
CPU		Pentium III 800 MHz or higher
Memory		256 MB or more
Drive	CD-ROM drive *1	1
	Hard disk	40 GB or more, and a revolution count of 7200 rpm or more
Interface		Ethernet 1000 Base-T

*1. CD-R/RW drive or DVD-ROM drive etc. can also be used.

■ Operation PC (for EZ Controller)

For details about the specification of the operation PC, see the **Specifications** of the EZ Controller.

Processing capacity

Approximate processing capacity (when roll paper is used)

Print size (Paper width × Paper advance length)	Capacity (Prints/hour) ^{*1}	
	Printing method:Standard	Printing method:Image quality priority
127 mm × 89 mm	750	450
152 mm × 102 mm	650	380
127 mm × 178 mm	420	235
203 mm × 254 mm	250	135
203 mm × 102 mm	560	330
203 mm × 305 mm	220	115
254 mm × 203 mm	280	150
254 mm × 305 mm	195	100
254 mm × 366 mm	165	85
254 mm × 914 mm	68	35

*1. Calculated according to our criteria. The actual processing capacities may differ depending on various conditions.

Approximate processing capacity (when sheet paper is used)

Print size (Paper width × Paper advance length)	Capacity (Prints/hour) ^{*1}	
	Printing method:Standard	Printing method:Image quality priority
210 mm × 297 mm	36	23
148 mm × 210 mm	45	30
182 mm × 257 mm	40	27
203 mm × 254 mm	38	26
216 mm × 279 mm	36	23

*1. Calculated according to our criteria. The actual processing capacities may differ depending on various conditions.

Dimensions and required space

Dimensions

- ◆ If the print sorter unit (option) is not installed

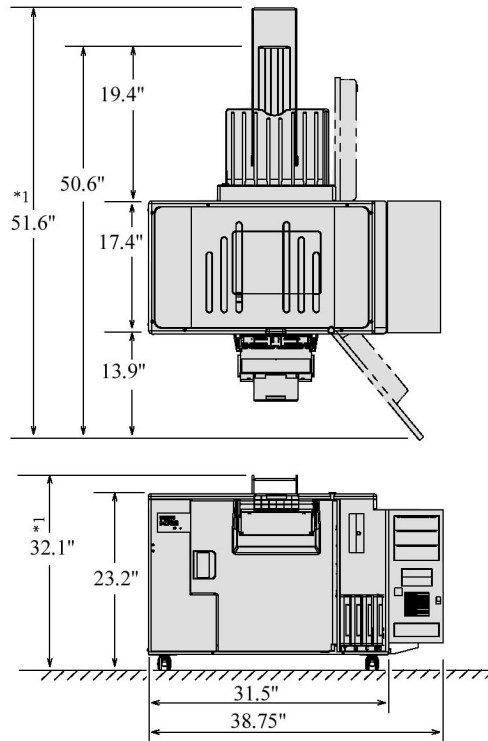

*1. When the long length print guide (option) is installed

G089376

- ◆ If the print sorter unit (option) is installed

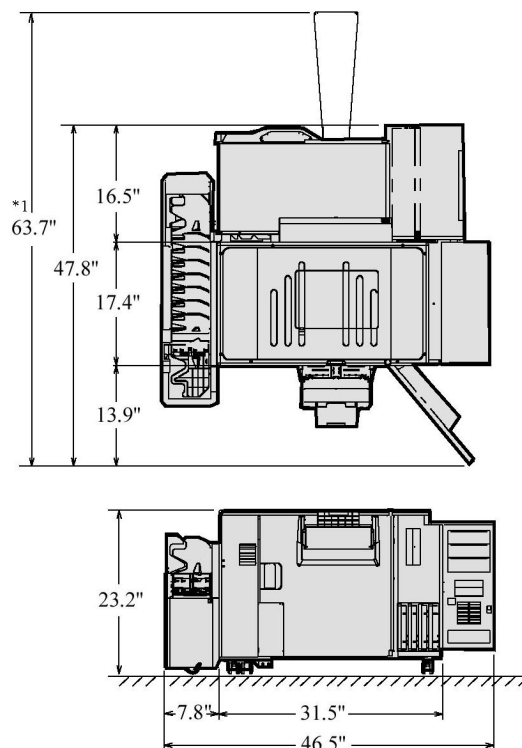

*1. When the long length print guide (option) is installed

G090537

Space required for installation

- ◆ If the print sorter unit (option) is not installed

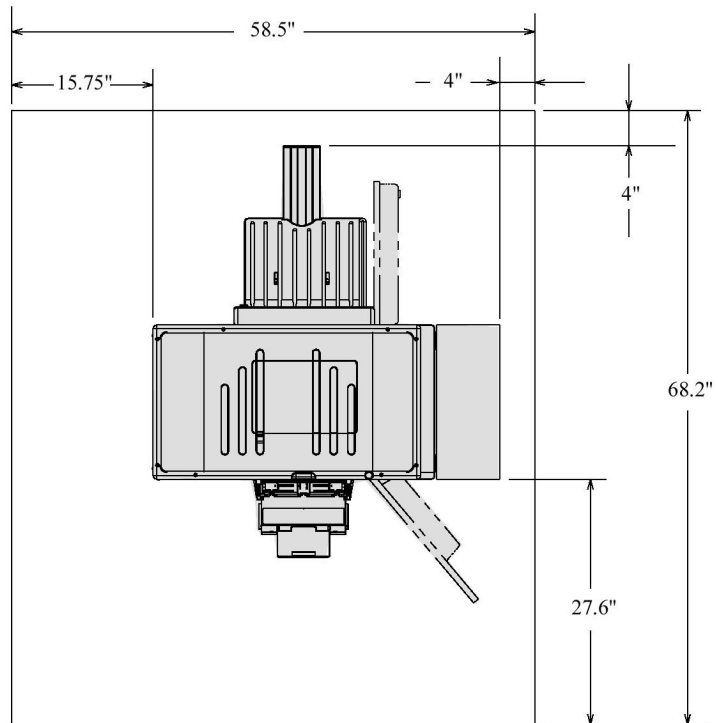

G089377

- ◆ If the print sorter unit (option) is installed

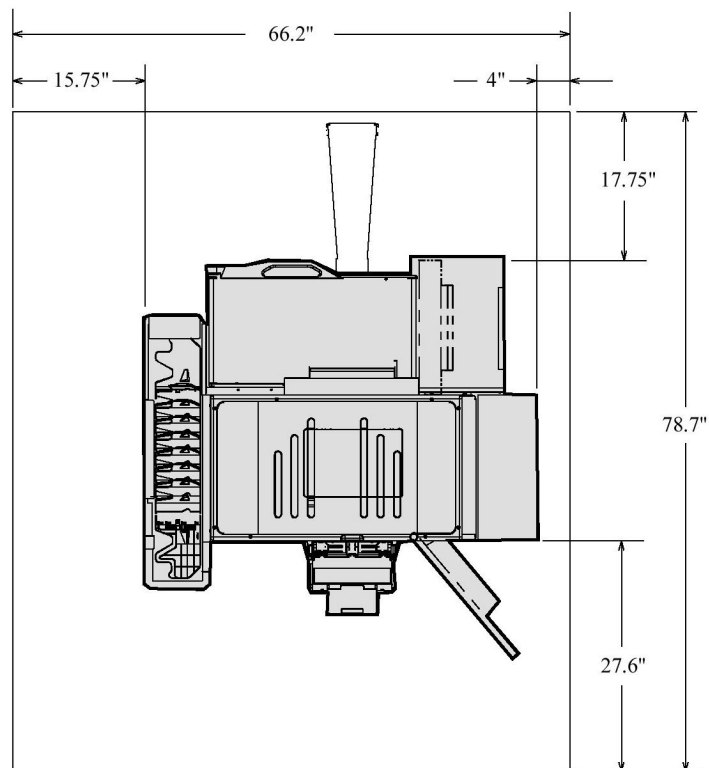

G090538

Standard equipment/Standard accessories

◆ Standard equipment

Item	Remarks
Paper cut system	Built-in
Dryer	Built-in
Automatic switcher for roll and sheet paper	Built-in
Castors	Attached
Moisture prevention kit	Built-in
Sheet supply device	Built-in
Paper supply tray load detection device	Built-in
Ink cartridge misarrange prevention system	Built-in
Interlock system	Built-in
USB port (USB2.0)	Built-in
D701 SYSTEM PROGRAM KIT	Included
USB cable	Included
Power cable (for the printer)	Included
Spindle unit	Included
Image Processing Module	Included
Initial Data	Included
Printhead Data	Included

◆ Standard accessory

Item	Quantity	Remarks
Wiper (cleaning cloth) (150 sheets)	1	Used to clean the ink blots.
Slow-blow fuse (3.15 A)	2	
Slow-blow fuse (6.3 A)	2	
Slow-blow fuse (1 A)	2	

Options

Optional items or option numbers are subject to change without notice. For details, contact your place of purchase.

Software

Option No.	Item	Explanation
Z810742-01	Noritsu Quick Access (Windows 2000 and Windows XP are supported.)	Software to send image data edited with an external PC to the printer via a network connection and print. For details about the PC specifications, see Specifications .

Hardware

Option No.	Item	Explanation
Z811340-01	Correction value printing unit (CVP)	Prints print data on the back of prints.
Z811342-01	Humidity conditioning kit	Controls the humidity for the loaded paper.
Z811341-01	Double-stack cabinet	Used to stack two printers.
B024782-01	Long print stocker (2)	Attach this stocker when making prints of which paper width is 203 mm or 254 mm, and the paper advance length is longer than 457 mm.
I090854-00	Personal computer	Used as the printer PC. (Printer PC: PC-NRT-RS18)
I068506-00	Power cord	A code for connecting the printer PC to the main power supply
Z026416-01	Spindle unit	Used to load roll paper to the printer.
H094040-00	Paper case	Used to store paper so that paper is not damaged by humidity.
A091134-01	Paper band	Used to fix the leading end of used paper.
Z811343-01	Print sorter unit	Unit to sort the finished prints by order
Z811332-01	Print sorter double-stack unit	Kit to attach the double-stack cabinet for the printer which equipped the print sorter unit.

Consumables

Option No.	Item	Explanation
H086044-00	Ink ribbon cassette	CVP ink ribbon
H086075-00	Ink cartridge (BK)	Dye ink cartridges Black (BK), Cyan (C), Magenta (M) Yellow (Y), 500 ml per color
H086076-00	Ink cartridge (C)	
H086077-00	Ink cartridge (M)	
H086078-00	Ink cartridge (Y)	
H089017-00	Wiper	Used to clean ink blots (150 sheets)

Use roll paper specified by Noritsu.

Option No.	Item	Explanation
H073128-00	Roll paper (Glossy)	127 mm × 100 m × 4 rolls (Glossy)
H073129-00	Roll paper (Glossy)	152 mm × 100 m × 4 rolls (Glossy)
H073130-00	Roll paper (Glossy)	203 mm × 100 m × 2 rolls (Glossy)
H073131-00	Roll paper (Glossy)	254 mm × 100 m × 2 rolls (Glossy)
H073132-00	Roll paper (Semigloss)	127 mm × 100 m × 4 rolls (Semigloss)

Option No.	Item	Explanation
H073133-00	Roll paper (Semigloss)	152 mm × 100 m × 4 rolls (Semigloss)
H073134-00	Roll paper (Semigloss)	203 mm × 100 m × 2 rolls (Semigloss)
H073135-00	Roll paper (Semigloss)	254 mm × 100 m × 2 rolls (Semigloss)
H073140-00	Sheet paper (Glossy)	210 mm × 307 mm 200 prints (Glossy)
H073141-00	Sheet paper (Glossy)	203 mm × 264 mm 200 prints (Glossy)
H073142-00	Sheet paper (Semigloss)	210 mm × 307 mm 200 prints (Semigloss)
H073143-00	Sheet paper (Semigloss)	203 mm × 264 mm 200 prints (Semigloss)

Installation requirements

- Use this system in a place where the relative humidity is from 30 to 75% and the temperature is from 15 to 30°C (59°F to 86°F). If this system is used in a place where the relative humidity is 30 % or lower or 75% or higher, it is recommended to use the humidity conditioning kit.
- Be sure to store the ink cartridge and roll paper within the following environment.
 - For ink cartridge:
Store the unopened ink cartridge within −30 to 40°C (−22°F to 104°F). (If the ink cartridge is to be stored in a place where the room temperature is near 40°C (104°F), then the maximum storage life is within one month.)



IMPORTANT

- Before using the ink cartridge, wait until the ink temperature becomes within the operation temperature of this system.
 - For roll paper:
Store them in a place where the relative humidity is from 20 to 80%, the temperature is from 15 to 25°C (59°F to 77°F) and without direct sunlight.
- Avoid installing the product in areas with high dust levels or subject to vibration.
 - Do not raise or lower the room temperature quickly. If you do so, moisture in the air is likely to condense in the system, causing paper jams, malfunctions in the electronics and PCBs, etc.
 - Castors are for moving the system. Once the machine has been positioned, be sure to fix them in place by locking the casters.
 - The declination of the floor on which this system is installed is 6/1000 or less (1.5Div or less) to the horizontal surface. The floor is not concave or convex around the casters. If the product is shaky, place a pad between the floor and caster to adjust the level.
 - The floor should have strength which supports the mass of 400 kg/m².
 - The system is programmed with default values prior to shipment. These values may differ depending on the environment and operating conditions. Change them as necessary.
 - Equipment complying with EN61000-3-12